

THE REQUIREMENTS FOR ACQUIRING PRODUCT(S) DESCRIBED HEREIN SHALL CONSIST OF THIS SPECIFICATION SHEET AND THE ISSUE OF THE FOLLOWING SPECIFICATION LISTED IN THAT ISSUE OF THE DOCSB SPECIFIED IN THE SOLICITATION: MIL-B-7949

THIS SPECIFICATION IS APPROVED FOR USE BY ALL DEPARTMENTS AGENCIES OF THE DEPARTMENT OF DEFENSE.

Form Approved
 OMB No. 0704-0188

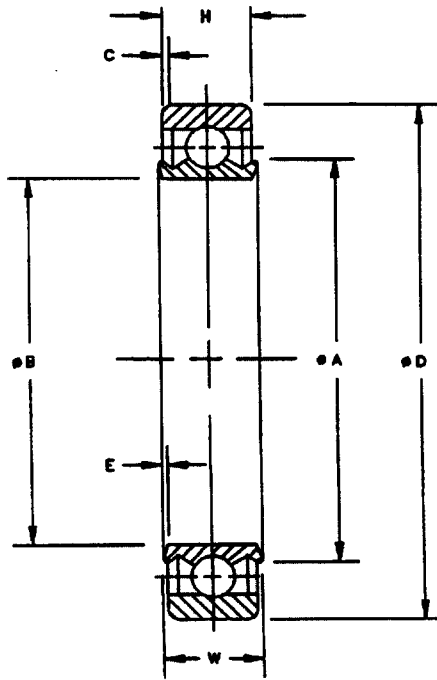

FIGURE 1. BEARING

TABLE I. DIMENSIONS AND LOADS

MS DASH NO.	ØB		ØD		W	H	ØA		E & C	RADIAL LIMIT LOAD RATING LBS	THRUST LIMIT LOAD RATING LBS	4/ RADIAL LOAD RATING (LBS.) FOR AVERAGE LIFE OF 10,000 COMPLETE 90° CYCLES		WEIGHT POUNDS (APPROX)	MAXIMUM STARTING TORQUE (INCH-ØZ)	
	5/ BORE	1/ OUTSIDE DIAMETER	6/ WIDTH INNER RING	1/ WIDTH OUTER RING			SHOULDER DIAMETER INNER RING APPROX.	CORNER CHAMFER X 45°				CASE I	CASE II			
								2/								3/
-38	.6250	1.0625					.777			3280	1300	1990	1820	.03	2	
-38	.7500	1.1875					.895			3730	1700	2050	1900	.04	2	
-40	.8750	1.3125					1.018			4230	1900	2110	1970	.05	3	
-41	1.0625	1.5000					1.218			5000	2200	2170	2020	.06	4	
-42	1.3125	1.7500	.281	.250			1.451	.015		5850	2700	2220	2130	.09	4	
-43	1.5625	2.0000					1.702			6880	3200	2280	2180	.10	5	
-44	1.8125 7/	2.2500 7/					1.970			7880	3800	2300	2220	.11	5	
-45	2.0625 7/	2.8250 7/					2.286			9220	4000	2340	2280	.15	6	
-46	2.3125 7/	2.8750 7/					2.527			10180	4400	2380	2280	.17	6	

- 1/ DIMENSIONS TO BE MET AFTER PLATING.
- 2/ A RADIUS GIVING APPROXIMATELY THE SAME GRIP FOR STAKING THE BEARING IN THE HOUSING WILL BE ACCEPTABLE.
- 3/ A RADIUS GIVING APPROXIMATELY THE SAME FILLET CLEARANCE WILL BE ACCEPTABLE.
- 4/ CASE I = LOAD FIXED WITH RESPECT TO OUTER RING.
 CASE II = LOAD FIXED WITH RESPECT TO THE INNER RING.
- 5/ THESE RATINGS ARE FOR OPERATION UP TO 250°F. WHEN SUBJECT TO OPERATION UP TO 350°F, THE RATINGS SHALL BE REDUCED BY 20 PERCENT.
- 6/ OUT-OF-ROUND TOLERANCES: BORE: -38 THRU -43 ±.0010; -44 THRU -46: ±.0016
 OUTSIDE DIAMETER: -38 THRU -43 +.0005, -.0015; -44 THRU -46: +.0008, -.0023
- 7/ FOR DASH NUMBER SIZES -44, -45, AND -46, THE OUTSIDE DIAMETER TOLERANCE SHALL BE +.0000 TO -.0015 INCHES.
- 8/ FOR DASH NUMBER SIZES -44, -45, AND -46 THE BORE TOLERANCE SHALL BE +.0010 TO -.0010 INCHES.

(F) DENOTES CHANGES

INCH-POUND

PREPARING ACTIVITY: NAVY-AS CUSTODIANS: ARMY- AV NAVY- AS AIR FORCE-99 DLA-	MILITARY SPECIFICATION SHEET TITLE BEARING, BALL, AIRFRAME, ANTI-FRICTION, EXTRA LIGHT DUTY	SPECIFICATION SHEET NUMBER MS27646 21 JUNE 95 REV F
REVIEW: ARMY-AR,ME, AF-84 DLA-IS USER: PROJECT NUMBER: 3110-0930		SUPERSEDING MS27646 E 05 DEC 94
DISTRIBUTION STATEMENT A Approved for public release; distribution is unlimited.		AMSC- N/A FSC -3110
		Page 1 of 2

